

DO NOT SCALE FROM THIS DRAWING. USE FIGURED DIMENSIONS IN ALL CASES.
VERIFY DIMENSIONS ON SITE AND REPORT ANY DISCREPANCIES TO THE ARCHITECTS IMMEDIATELY. THIS DRAWING IS TO BE READ IN CONJUNCTION WITH THE ARCHITECTS SPECIFICATION. © THIS DRAWING IS COPYRIGHT AND MAY ONLY BE REPRODUCED WITH THE ARCHITECTS PERMISSION.

PROPOSED GLEBE HOUSE

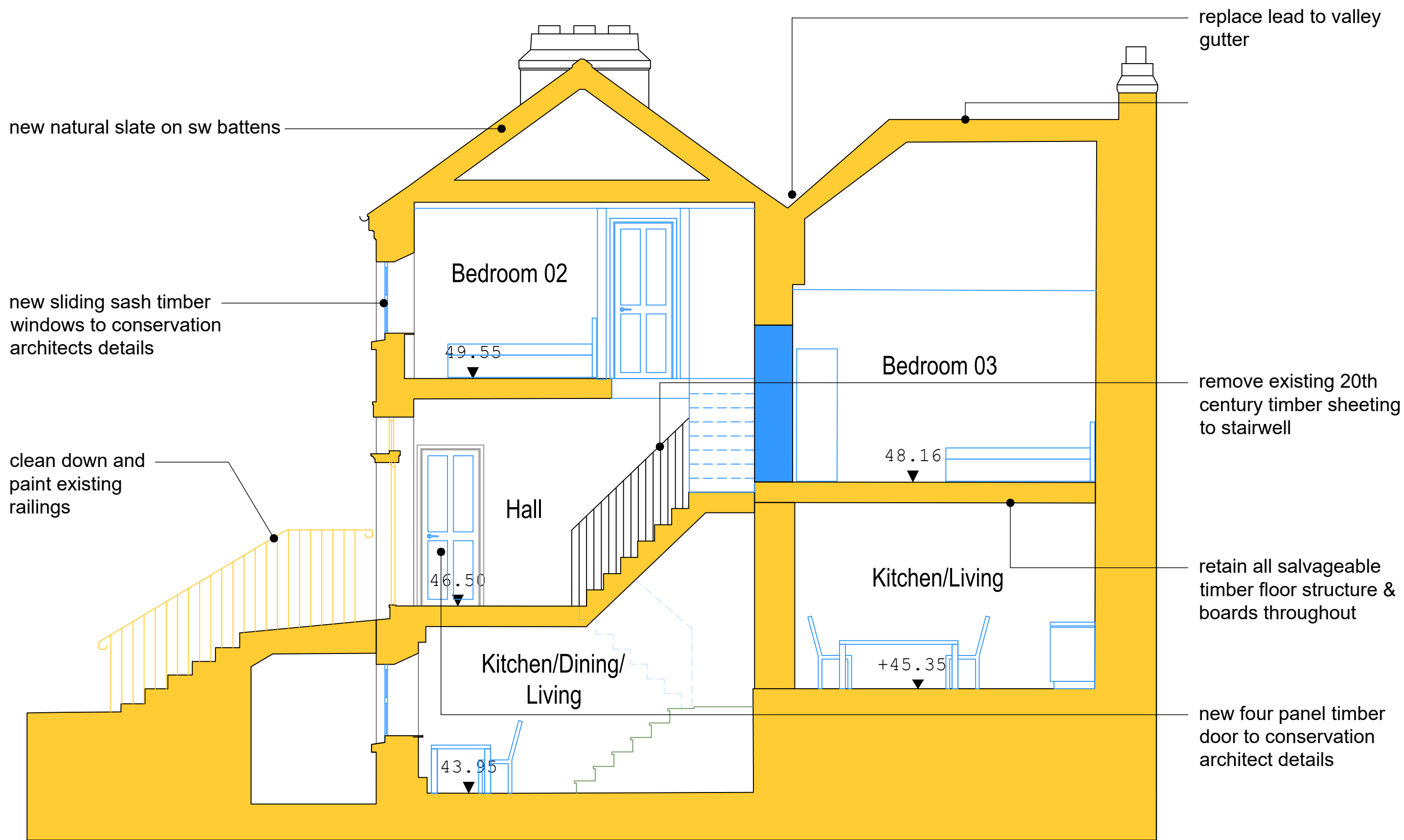

Section A-A



Section B-B

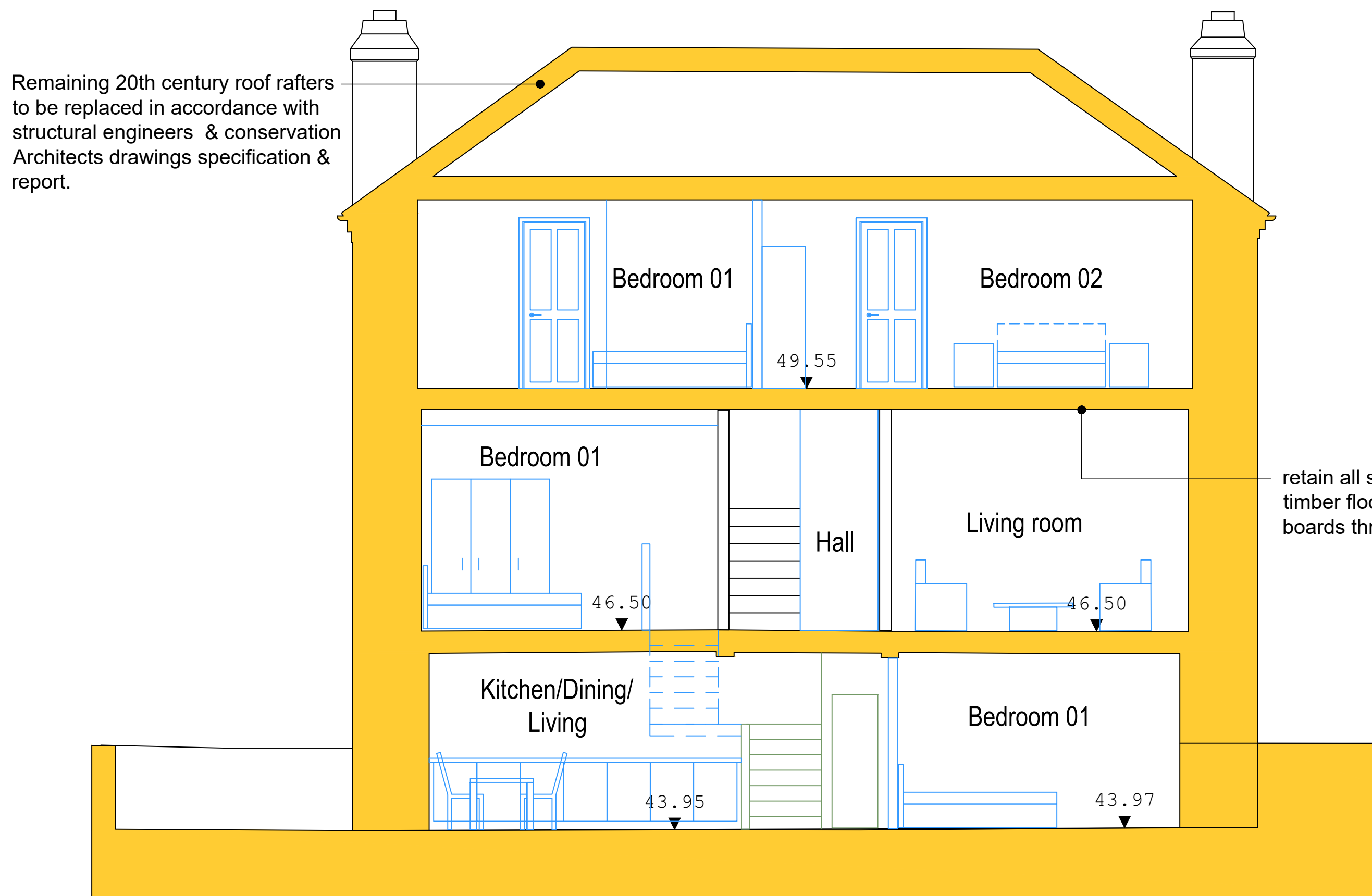

Section C-C

Remaining 20th century roof rafters to be replaced in accordance with structural engineers & conservation Architects drawings specification & report.

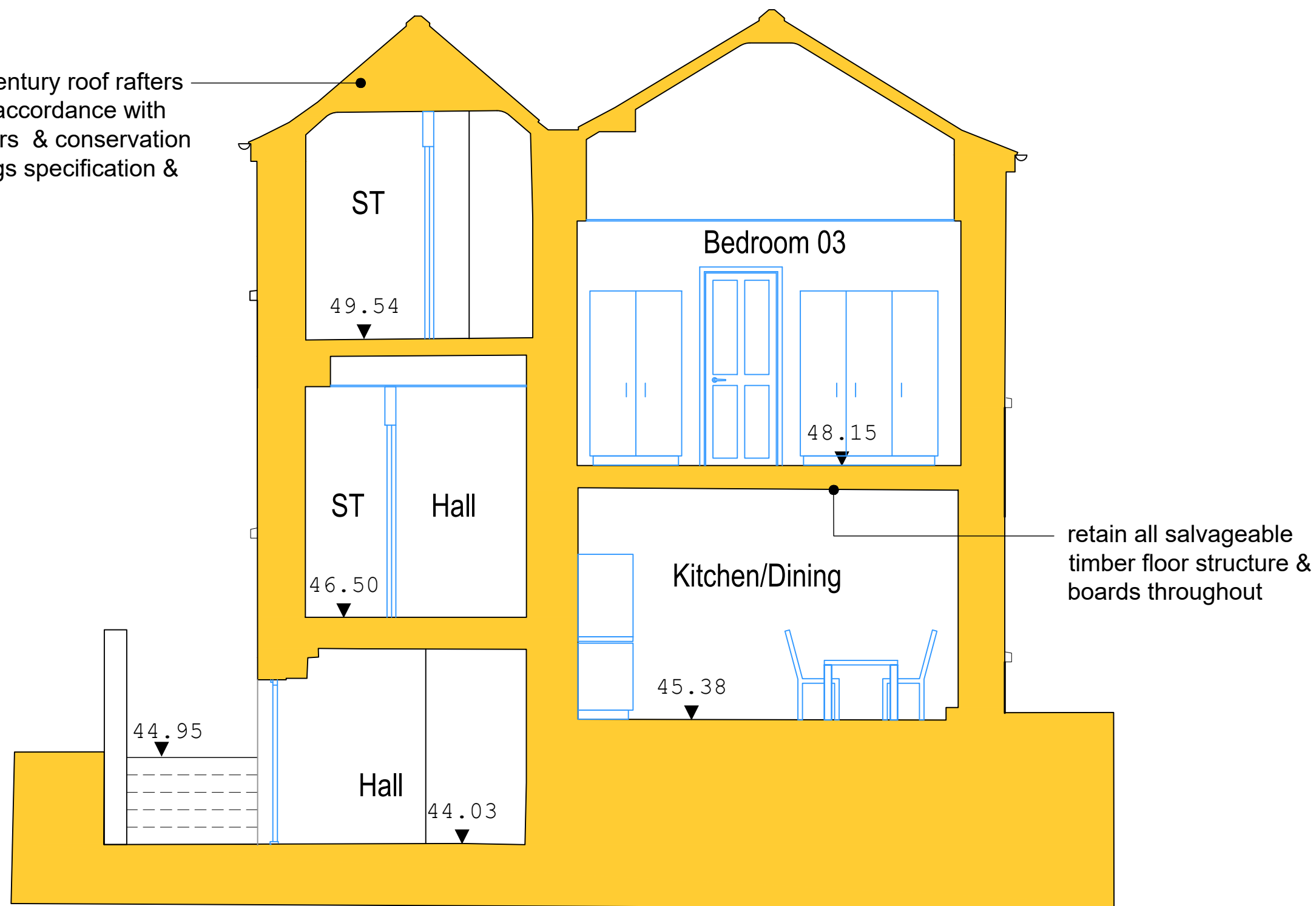

Section D-D

- 18th/19th Century high significance
- mid late 20th Century low significance
- Proposed new Works

P01	June 2022	LG	PLANNING	ISSUE	
REV	DTE	DRN	ISSUE		



3.0 PLANNING

JOB Glebe House Residential Development St. Agnes Road, Crumlin, Dublin.		
CLIENT Seabren Developments Ltd and Circle VHA CLG		
DRAWING GLEBE HOUSE DRAWINGS PROPOSED SECTIONS		
DATE	June 2022	SCALE
DRN.	N. Britz	CHECKED
JOB NO.	DWG NO.	REVISION
P19171D	133	P01